

A WALK THROUGH UTICA STATION

Concourse

When you enter the structure, you're on the top floor of a three-level station. This is called the Concourse Level. Here you'll find public phones, passenger assistance phones, ticket vending machines, train schedules, maps of the neighborhood and the system, and information as to how to ride Metro Rail.

In addition to being located on all levels, passenger assistance phones are available on all elevators. To operate them, merely push a button and you'll be in contact with personnel at our Operations Control Center downtown.

If you do not already have a transfer, student pass or a commuter card, be sure to buy your ticket at this level. A sign located above the ticket vending machines warns you that you are not allowed to travel past this area without PROOF OF FARE PAYMENT.

In fact, always have your ticket, student pass, transfer, or commuter card handy. They show that you have paid for your ride. From time to time, an NFTA Ticket Inspector may ask you to present your proof-of-payment. You must comply when requested. That is the law. Failure to prove that you have paid for your ride will result in a summons with a fine to follow.

All of our subway stations feature glass enclosed

elevators as well as escalators and stairs to take you to the levels below.

Mezzanine

The Mezzanine is located between the Concourse (first level) and the Platform Level (third level). At this level, you will transfer from one set of escalators, elevators or stairs to another to reach the third level.

Platform Level

You'll get on your train at this level by using one of two 300-foot long inbound or outbound boarding platforms.

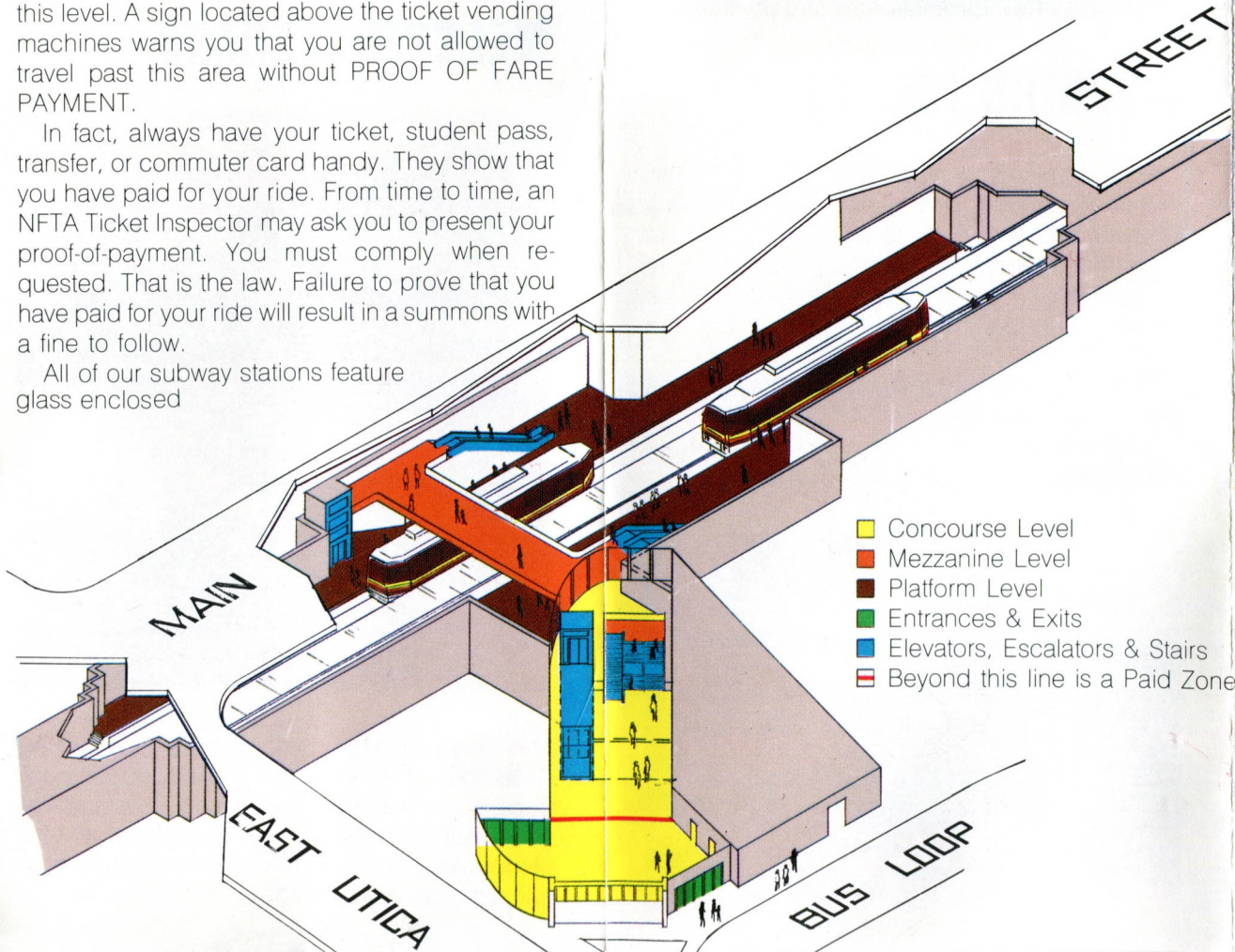

- Concourse Level
- Mezzanine Level
- Platform Level
- Entrances & Exits
- Elevators, Escalators & Stairs
- Beyond this line is a Paid Zone

POINTS OF INTEREST

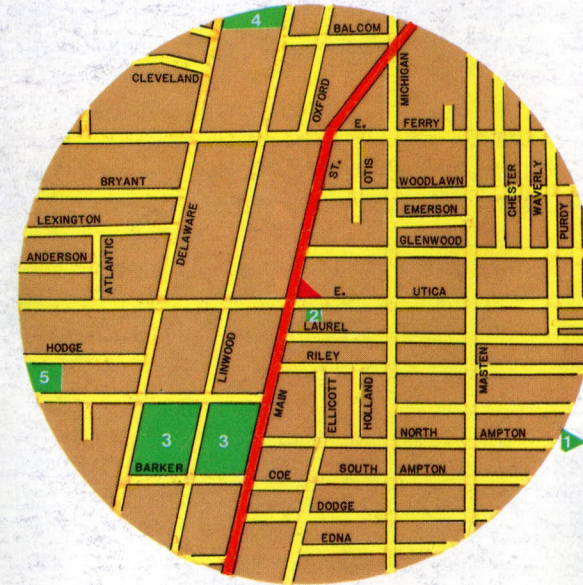

■ Utica Station

1. Deaconess Hospital
2. Center for Positive Thought Cultural Complex
3. Linwood Medical Center
4. Millard Fillmore Hospital
5. Children's Hospital

Prepared by:
NFTA Public Relations Department
181 Ellicott Street, Buffalo, New York 14205

The Niagara Frontier Transportation Authority

A State of New York Public Benefit Corporation which owns and operates:

- Greater Buffalo International Airport
- Niagara Falls International Airport
- Port of Buffalo
- Metropolitan Transportation Center plus Metro Bus and Metro Rail

BOARD OF COMMISSIONERS

- RAYMOND F. GALLAGHER, Chairman
- JAMES H. WOLFORD, Vice Chairman
- GEORGE L. WESSEL, Treasurer
- EDDIE L. PALMORE, Secretary
- RICHARD C. SOUTHARD, Assistant Secretary
- ROBERT D. GIOIA
- WILLIAM G. GISEL
- ERNESTINE R. GREEN
- RONALD J. ANTHONY
- GLENN S. HACKETT
- JAMES M. WADSWORTH
- JOSEPH D. LATONA, Executive Director

YOUR UTICA STATION

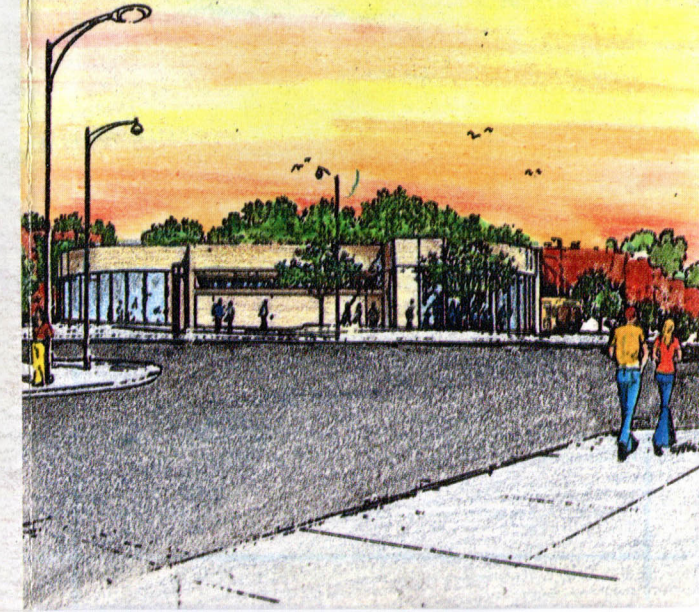

The Niagara Frontier Transportation Authority welcomes you to the City of Good Neighbors' METRO RAIL!

Buffalo's 6.4 mile light rail rapid transit line runs along and underneath Main Street, from Memorial Auditorium to the University of Buffalo South Campus, with 14 stations - 6 on surface and 8 in subway (underground).

This brochure describes and gives you information about one of the eight subway stations, the **UTICA STATION.***

OUTSIDE THE STATION

Utica Station is situated on the northeast corner of Main and East Utica Streets. The site that it occupies was once the home of the Hotel Markeen, a famous and popular "night spot" in the 1950's.

A large bus loop is located at the rear of the station. Here Metro Buses pull in and drop off passengers who wish to continue their trip on Metro Rail.



Construction and Design

The prime contractor for the station was John W. Cowper, Inc. Buffalo, New York. Designers of the building were WVKR, Inc. of Alexandria, Virginia. Buff-colored, limestone panels make up the exterior construction. Round in design, it blends in well with the architecture of the surrounding area.

ART AND TRANSIT

Besides constructing the finest rail transit line in the country, NFTA took advantage of a unique opportunity. It specifically planned and developed a public art program in conjunction with the Metro Rail System.

Represented at UTICA STATION are the following artists with a brief description of their work:

George Smith (a native of Buffalo, now living in New York City)...a large stainless steel sculpture based on the art and architecture of the Dogon people of Africa.

Craig Langager (New York, NY)...a series of 8 contemporary figures in both human and animal form. Each one of four is duplicated one time and positioned on opposite sides of each of four central columns so as to create a mirror image (below).



Margie Hughto (Syracuse, NY)...a heavily glazed clay painting covering the interior wall of the Concourse Level and then descending to the lower level (above right).



WORKING TOGETHER

Metro Bus is an integral part of the Metro Rail System. Selected routes provide what is called a feeder bus network. They transport you to and from Metro Rail Stations and provide free transfer to trains. Even if you live quite a distance from the Metro Rail line, you can board a feeder bus and transfer to the train.

Metro Buses serving the Utica Station are No. 8 (Main Street - limited service), and No. 12 (Utica), and No. 13 (Kensington - City). Route schedules are available at the station or from Metro Bus.



FARES

The cost of a Metro Rail ticket is the same as the Metro Bus fare. Transfers are honored from Metro Bus to Metro Rail or Metro Rail to Metro Bus, free of charge.

If you would like more information or help in planning any transit trip, be it Metro Rail or Metro Bus, please call (716) 855-7211 for assistance.

WELCOME ABOARD. RETAIN THIS TICKET

This ticket is your proof of payment and must be surrendered for inspection upon request. It is valid only within one hour from the time shown on the opposite side for travel on a train away from the issuing station or within the paid area by a person entitled to use the indicated passenger category.

WELCOME ABOARD



* Additional brochures pertaining to Metro Rail, Fare Collection, Art in the Stations, Passenger Safety and Security, or Ridership for Senior Citizens and Persons with Disabilities are available at our Metropolitan Transportation Center or any one of our stations free of charge.